

STRUT POST PL200/PL400 BALUSTRADE SYSTEM

Installation / Fitting Instructions

(PL200 & PL400) Strut Post

Product	Installation/Fitting Instructions
Substrate Preparation	<ul style="list-style-type: none"> • A Design engineer must ensure the structure can support the appropriate loads • All fixings must be Stainless Steel
Installation of the Strut Post to the Supporting Structure	<ul style="list-style-type: none"> • Please refer to the detailed PS1 which contains fixing details for respective substrates, windzones and occupancy types
Elevations showing main features	<p>PL200 Base Fix Strut Post Refer Page 285.</p> <p>Notes:</p> <ol style="list-style-type: none"> 1. Clamp panels, 3mm SS and Gasket material. Held in place with Double sided tape 2. Glass Clamping - Tighten bottom grubscrew first, then two top screws. Do not over tighten, max torque 5Nm. 3. MP Cover Panels. Held in place with Double sided tape 4. Use top grub screw for vertical alignment of the glass panel. 5. Ensure that the glass panel is not in contact with any of the Strut post 6. For height adjustment pack the bottom of the glass with additional bottom gaskets as required.
Elevations showing main features	<p>PL200 Base Fix with Gutter Bracket Strut Post Refer Page 286.</p> <p>Notes:</p> <ol style="list-style-type: none"> 1. Clamp panels, 3mm SS and Gasket material. Held in place with Double sided tape 2. Glass Clamping - Tighten bottom grubscrew first, then two top screws. Do not over tighten, max torque 5Nm. 3. MP Cover Panels. Held in place with Double sided tape. 4. Use top grub screw for vertical alignment of the glass panel. 5. Ensure that the glass panel is not in contact with any of the Strut Post 6. For height adjustment pack the bottom of the glass with additional bottom gaskets as required.

STRUT POST PL200/PL400 BALUSTRADE SYSTEM

Installation / Fitting Instructions

Product	Installation/Fitting Instructions
Elevations showing the main features	<p>PL400 Side Fix Strut Post. Refer Page 235.</p> <p>Notes:</p> <ol style="list-style-type: none"> 1. Clamp panels, 3mm SS and Gasket material. Held in place with Double sided tape 2. Glass Clamping - Tighten bottom grubscrew first, then two top screws. Do not over tighten, max torque 5Nm. 3. MP Cover Panels. Held in place with Double sided tape 4. Use top grub screw for vertical alignment of the glass panel. 5. Ensure that the glass panel is not in contact with any of the Strut post 6. For height adjustment pack the bottom of the glass with additional bottom gaskets as required.
Cleaning	<p>Once everything is correctly in place and the job is complete, the glass and disc need to be cleaned. Use a non-abrasive glass cleaner on the glass and warm soapy water on the PL200/PL400 Strut Post. We also recommend a soft sponge or cloth, again to avoid any risk of scratching. For full care and maintenance guidelines please refer to our comprehensive guide. Pages 778-779.</p>

STRUT POST PL200 BALUSTRADE SYSTEM

Installation / Fitting Instructions

BASE FIX (PL200) Strut Post

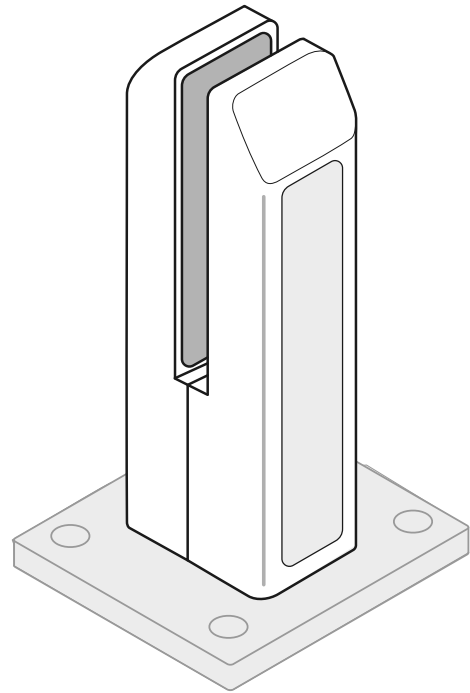
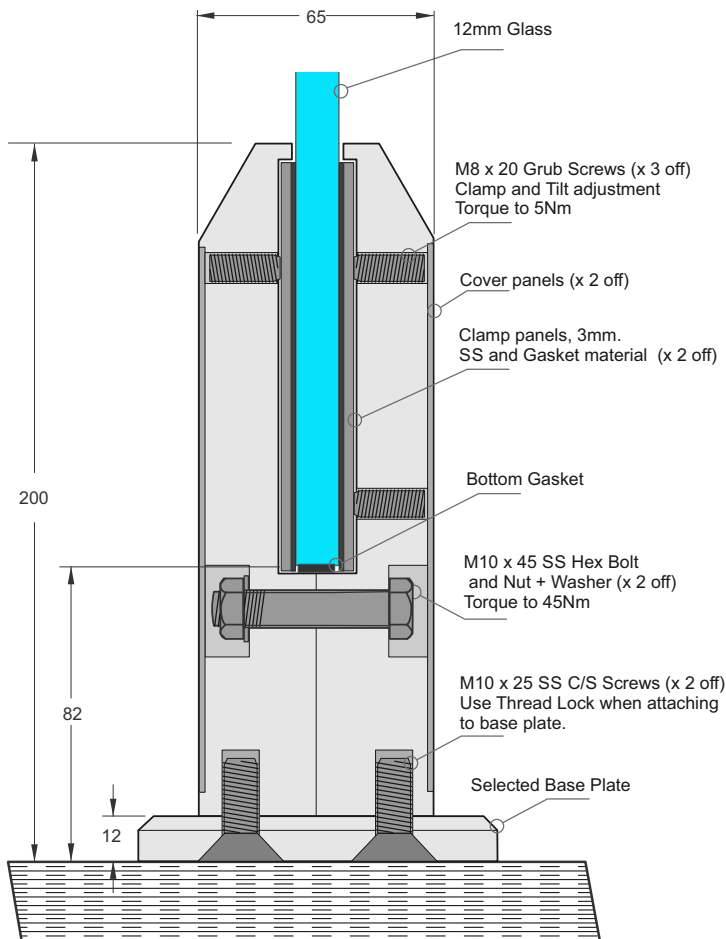

NOTES:

- 1 Clamp panels, 3mm SS and Gasket material. Held in place with double sided tape.
- 2 Glass Clamping - Tighten bottom grub screw first, then two top screws. Do not over tighten, max torque 5Nm.
- 3 MP Cover Panels. Held in place with double sided tape.
- 4 Use top grub screw for vertical alignment of the glass panel.
- 5 Ensure that the glass panel is not in contact with any of the Strut Post.
- 6 For height adjustment pack the bottom of the glass with additional bottom gaskets as required.

Important note: The guide above is simplified, and should in no way be referenced in isolation. For full comprehensive substrate fixing details please refer through to the PS1.

STRUT POST PL200 BALUSTRADE SYSTEM

Installation / Fitting Instructions

BASE FIX TO GUTTER BRACKET (PL200) Strut Post

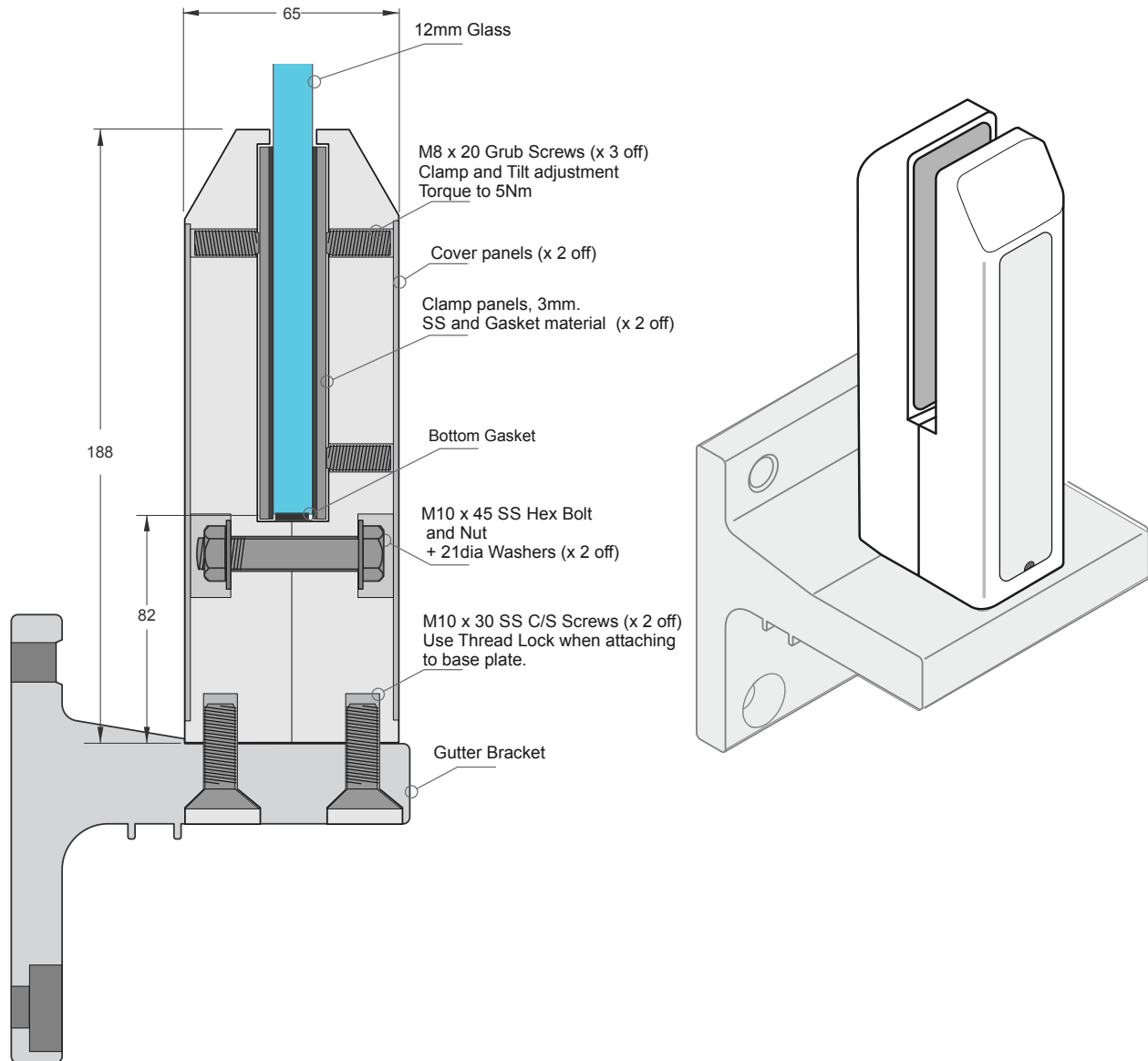

NOTES:

- 1 Clamp panels, 3mm SS and Gasket material. Held in place with double sided tape.
- 2 Glass Clamping - Tighten bottom grubscrew first, then two top screws. Do not over tighten, max torque 5Nm.
- 3 MP Cover Panels. Held in place with double sided tape.
- 4 Use top grub screw for vertical alignment of the glass panel.
- 5 Ensure that the glass panel is not in contact with any of the Strut Post.
- 6 For height adjustment pack the bottom of the glass with additional bottom gaskets as required.

STRUT POST PL400 BALUSTRADE SYSTEM

Installation / Fitting Instructions

SIDE FIX (PL400) Strut Post

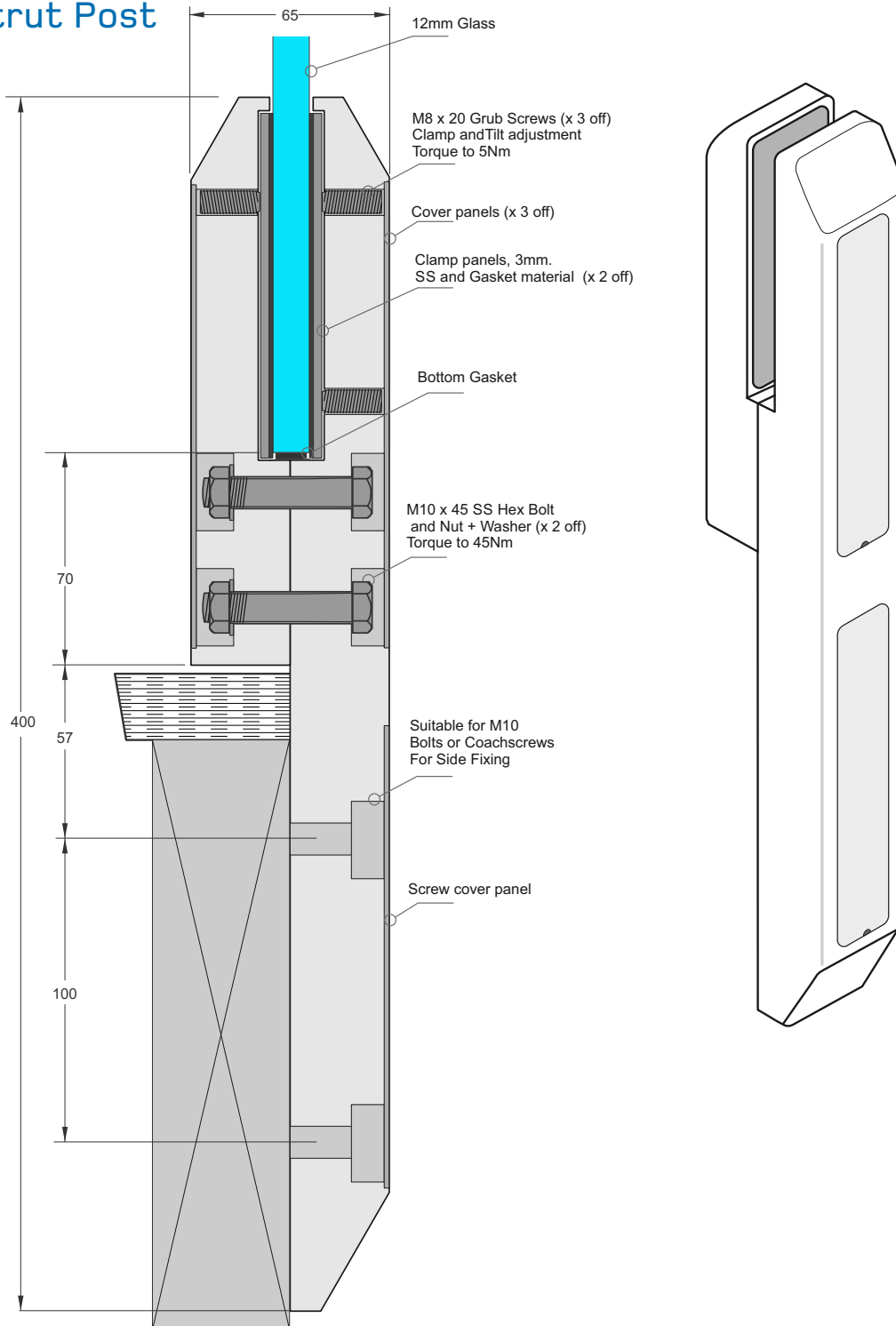

NOTES:

- 1 Clamp panels, 3mm SS and Gasket material. Held in place with double sided tape.
- 2 Glass Clamping - Tighten bottom grub screw first, then two top screws. Do not over tighten, max torque 5Nm.
- 3 MP Cover Panels. Held in place with double sided tape.
- 4 Use top grub screw for vertical alignment of the glass panel.
- 5 Ensure that the glass panel is not in contact with any of the Strut Post.
- 6 For height adjustment pack the bottom of the glass with additional bottom gaskets as required.